

JS-WP272HD

- **HDBT™**
- **HDCP**
- **4K**
- **1080P/60Hz**
- **PoC**



Overview

JS-WP272HD is a Wall Plate which supports HD conversion and long distance transmission. It can transmit HDMI signal up to 70 meters over one CAT cable (Pair Cable Type: CAT5, CAT5E, CAT6) which is easy to install.

JS-WP272HD delivers uncompressed video & digital audio to a network of devices or to a single device (point to point). It supports resolutions up to 1080P@60Hz and Blu-Ray Player and it is HDCP Compliant (Optional).

Product Features

- Transmits HDMI signal up to 70 meters over the twisted pair cable;
- Supports 1920x1200 1080p@60Hz;
- Input: HDMI;
- HDBaseT compliant;
- Supports PoC function.

Main Specification

Model : JS-WP272HD

Dimensions: Panel: 115mm*115mm
 Wall Cutout Dimension: 100mm*100mm*67mm
 Table Cutout Dimension: 92mm*72mm*39mm

Video : Input: HDMI
 Resolution Support: up to 1920 x 1080P @ 60Hz
 Clock Jitter: <0.2UI
 Transmission Delay (Max): 5ns (±1ns)
 Signal Type: DVI-D TMDS signal in DVI1.0 standard
 Signal Strength T.M.D.S: 800mVp-p
 DDC: Built-in
 HDCP: Support HDCP1.4
 Output: RJ45 + PoC
 Output Signal Level Range: 1000mV
 Output Impedance: 100 ohms
 Data Rate: 20 Gbps
 Twisted Pair Cable Length: Up to 70 meters

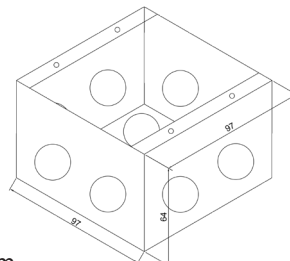

Bottom Box Dimension (mm)

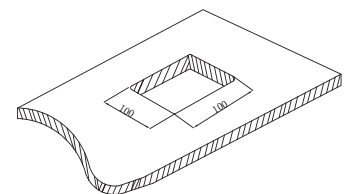

Wall Cutout Dimension (Please match with bottom box) (mm)

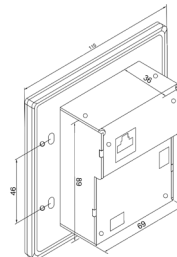

Overall Dimension (mm)

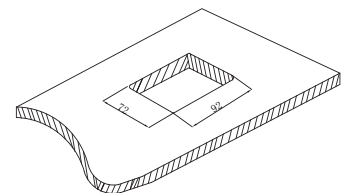

Table Cutout Dimension (mm)

AUDIO: Gain: 0dB
 THD+N (Total Harmonic Distortion plus Noise): 0.05% @1kHz (Rated Voltage)
 Frequency Response: 20Hz-20KHz
 CMRR: >75dB @ 20Hz-20KHz
 Input Impedance: >10k omhs
 Input Level(Max): +21 dBu

ENVIROMENTAL: Power Input Connector: 3P Phoenix
 Input: DC24V
 Current: 0.75A
 Output: DC24V . Provides extra 3P Phoenix interface for power daisy chain
 Supports: PoC
 Power: ≤ 20W
 Temperature (Storage): -20° to 150°C
 Temperature (Operating): -10° to 55°C
 Humidity: 20% to 95%, RHL non-condensing



Application



Bottom

Connection diagram

